



County of Fairfax, Virginia

MEMORANDUM

DATE: April 14, 2011

TO: Distribution List

FROM: Barbara C. Berlin, AICP
Director
Zoning Evaluation Division
Department of Planning and Zoning

SUBJECT: Special Exception Plat Analysis

REFERENCE: Application Number: SEA 2005-SU-020-2

Attached for your review and comment is the Special Exception application, Statement of Justification, Location map and Special Exception Plat for the subject application.

Action addressees are requested to provide written comments to staff coordinator by 5/5/2011 to be considered in preparing staff's recommendation on this application. Information addressees who wish to submit comments should provide them by the same date.

Special Exception Plats should be reviewed in accordance with the relevant provisions of the Zoning Ordinance, particularly:

- _____ Zoning District, Section
- _____ Submission Requirements, Section 9-011
- _____ General Standards, Section 9-006
- _____ Standards for All Category _____ Uses _____, Section
- _____ Additional Standards, Section
- _____ Other Comments:

Action Addressees

- _____ DPWES
Plan Control
Attn: Ken Williams
- _____ Dept. of Transportation
Transportation Planning,
Chief, Site Analysis Section
Attn: Angela Rodeheaver
- _____ Dept. of Planning & Zoning
Planning Division
Chief, Env. And Develop. Review Branch
Attn: Pam Nee
- _____ Fairfax County Park Authority
Planning and Development Division
Plan Review Coordinator
Attn: Lynne Johnson
- _____ Planning Commissioner
Swily District
- ✓ Supervisor
Swily District

- _____ DPWES
Sanitary-Sewer
Attn: Gilbert Osei-Kwadwo
- _____ Health Department
Div. of Environmental Health
Environ. Hazard Investigations
Section
Attn: Kevin Wastler
- _____ Dept. of Information Technology
Network Services Division
Radio Engineer, The Radio Center
- _____ Office of Community Revitalization &
Reinvestment
Office of County Executive
Attn: Barbara Byron
- _____ Dept. of Facilities Management
Analyst, Property Management Div.
Attn: Marguerite Guarino

- _____ Branch Chiefs, RZ/SE Branch, ZED
Dept. of Planning & Zoning
- _____ DPZ-ZED
Chief, Proffer Interpretation
Attn: Kevin Guinaw
- _____ DPZ-ZED
Admin. Asst, Applications Mgt. Branch
Attn: Lori Mallam
- _____ DPZ-PD
Chief
Attn: Fred Seiden
- _____ Northern Virginia Soil & Water
Conservation District
Conservation Specialist
Attn: Willie Woode
- _____ Southeast Fairfax Development Corp.
Attn: Tony Fontana

Information Addressees

- _____ Clerk to the Board of Supervisors
Attn: Nancy Vehrs
- _____ Planning Commission
Executive Director
Attn: Barbara Lipa
- _____ DPZ-ZED, Director
Attn: Barbara C. Berlin, AICP

- _____ VDOT
Attn: Deborah Townley
- _____ Economic Development Authority
Dir, Market Research and Comm.
Attn: Nate Edwards
- _____ Adult Aging Services, DFS
AAA, B-3-708
Attn: Jacquie Woodruff

Action Addressees - As Required

- _____ DPWES
Office of Site Development Services
Chief, Urban Forestry Branch
Attn: Jim McGlone

Department of Planning and Zoning
12055 Government Center Parkway, Suite 801
Fairfax, Virginia 22035-5509
Phone 703 324-1290
FAX 703 324-3924
www.fairfaxcounty.gov/dpz/



Special Exception Amendment

SEA 2005-SU-020-02

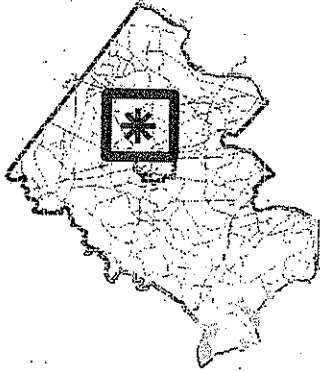

Applicant: DOMINION CHRISTIAN SCHOOL AND WHOLE WORLD FELLOWSHIP AND CHURCH AT NORTHERN VIRGINIA
Accepted: 04/01/2011
Proposed: AMEND SE 2005-SU-020 PREVIOUSLY APPROVED FOR CHURCH WITH PRIVATE SCHOOL OF GENERAL EDUCATION AND TELECOMMUNICATIONS FACILITY TO PERMIT BUILDING ADDITIONS, INCREASE IN ENROLLMENT, MODIFICATION DEVELOPMENT CONDITIONS AND SITE MODIFICATIONS
Area: 17.59 AC OF LAND; DISTRICT - SULLY
Zoning Dist Sect: 03-0E04, 03-0E04
Art 9 Group and Use: 3-15 1-05
Located: 10922 VALE ROAD
Zoning: R- E **Plan Area:** 2
Map Ref Num: 037-1- /01/ /0017 /01/ /0017A
Staff Coordinator: Kelli Goddard-Sobers
Pre-staffing: 5/9/11 **Staffing:** 6/23/11 **PC Hearing:** 9/15/11

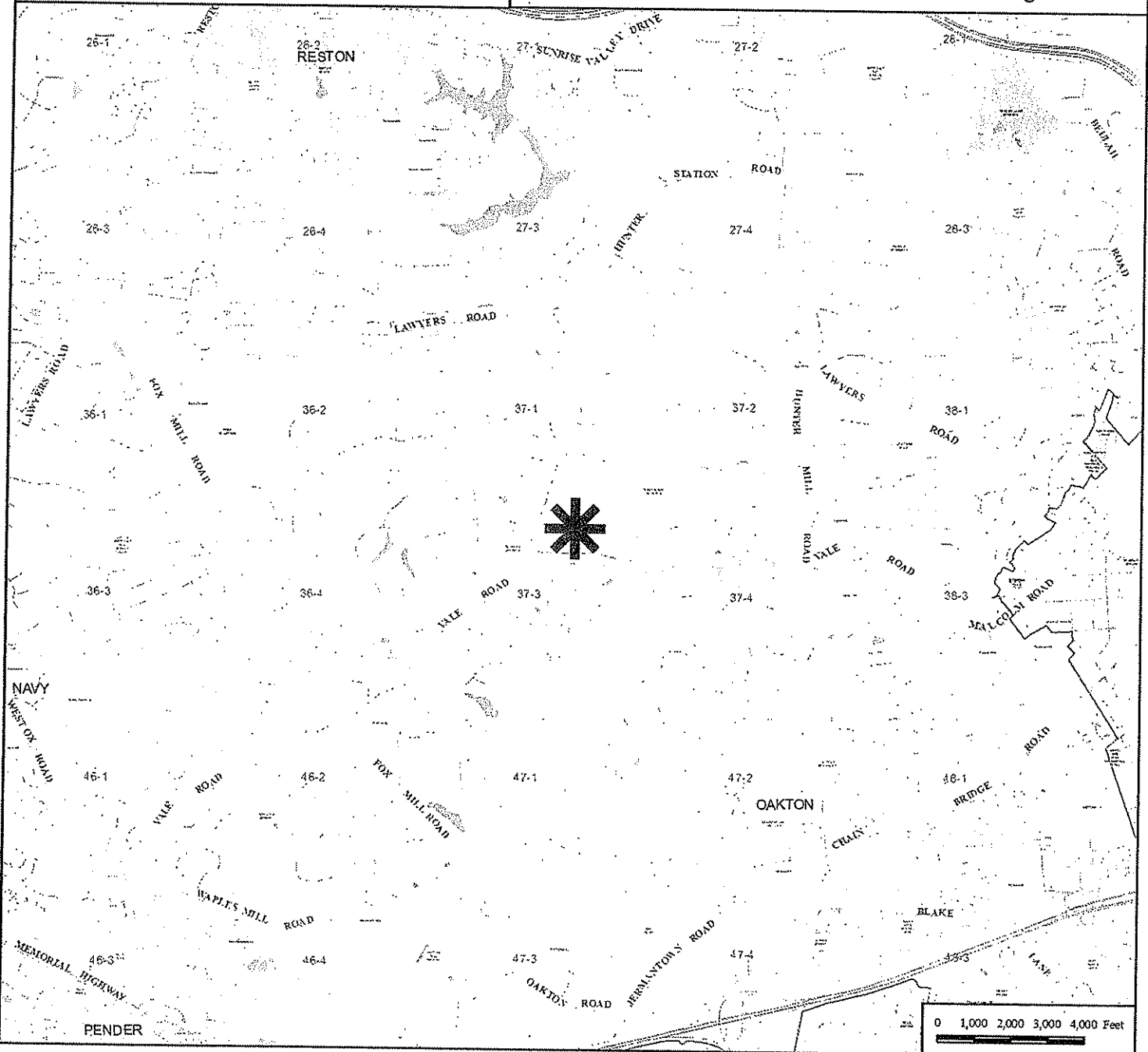

Special Exception Amendment

SEA 2005-SU-020-02

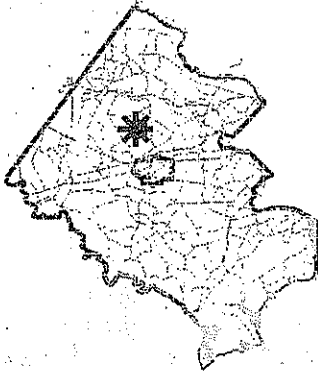

Applicant: DOMINION CHRISTIAN SCHOOL AND WHOLE WORLD FELLOWSHIP AND CHURCH AT NORTHERN VIRGINIA
Accepted: 04/01/2011
Proposed: AMEND SE 2005-SU-020 PREVIOUSLY APPROVED FOR CHURCH WITH PRIVATE SCHOOL OF GENERAL EDUCATION AND TELECOMMUNICATIONS FACILITY TO PERMIT BUILDING ADDITIONS, INCREASE IN ENROLLMENT, MODIFICATION DEVELOPMENT CONDITIONS AND SITE MODIFICATIONS
Area: 17.59 AC OF LAND; DISTRICT - SULLY
Zoning Dist Sect: 03-0E04, 03-0E04
Art 9 Group and Use: 3-15 1-05
Located: 10922 VALE ROAD
Zoning: R-E Plan Area: 2
Map Ref Num: 037-1- /01/ /0017 /01/ /0017A
Staff Coordinator: Kelli Goddard-Sobers
Pre-staffing: 5/9/11 Staffing: 6/23/11 PC Hearing: 9/15/11

