



## EXTERIOR SIGN PLAN

Lincoln Property Company  
Lincoln at Discovery Square  
Herndon, Virginia

Created : March 27, 2015  
Revision 1: April 2, 2015  
Revision 2: April 15, 2015  
Revision 3: May 19, 2015  
Revision 4: May 20, 2015  
Revision 5: June 30, 2015  
Revision 6: August 4, 2015  
Revision 7: Sept. 11, 2015  
Revision 8: Sept. 29, 2015  
Revision 9: Oct. 14, 2015

Prepared By:



ad vice studios, LLC  
6400 mechanicsville turnpike, suite 200  
mechanicsville, va 23111  
phone:(804) 730-0503 fax:(804) 746-5210  
www.advicestudios.com

© Copyright ad vice studios, LLC 2015

Sign Type/Description	Zoning Ordinance Section	Sign Dimensions*	Sign Height Above Grade	Article 12 Allowable Sign Area (Square Feet)	Total Proposed Sign Area (Square Feet)	Difference Between Proposed and Allowable (Square Feet)
X5.01: Building Mounted Identification	12-202 (2)	7'4"; 4'0"; 3'0"; 38' 2¼"; 2'10"; 38' 2¼"; 1'6"; 4'0"	57'	12 square feet	137.53 * 1 = 137.53 SF	+125.53 SF
X5.02-a: Building Mounted Identification	12-202 (2)	11'0"; 3'4"; 37'2"; 2'8"; 48'2"; 6'0"	15'6"	12 square feet	165.11 * 1 = 165.11 SF	+153.11 SF
X5.03.01 & X5.03.02: Building Mounted Parking Identification Signs	12-103 (2) (G)	6'3¼"; 1'0"; 6'3 ¼"; 1'0"	13'5"	2 square feet	6.27 * 2 = 12.54 SF	+4.27 SF each + 8.54 SF total
X5.06: Building Mounted – Emergency Vehicle Sign	12-103 (2) (G)	2'6"; 1'6"; 2'6"; 1'6"	15'	2 square feet	3.75 * 1 = 3.75 SF	+1.75 SF
X5.04.01 & X5.04.02: Building Mounted Garage Identification Signs	12-103 (2) (G)	9'0";0'8"; 9'0";0'8";; 9'0"; 0'8"; 9'0";0'8"	Approx. 9', final height dependent on garage clearance	2 square feet	12.00 * 2 = 24 SF	+10.00 SF each +20.00 SF total
BI.01-BI.12: Building Mounted Incidental Wall Signs	12-103 (2) (G)	2'1" 1'11"	6'6"	2 square feet	4.00 * 12 = 48.00 SF	+ 2.00 SF each + 24.00 SF total

\* Sign Dimensions: Lengths listed are lengths of 8 lines used for calculating sign area beginning at the upper left most intersection and moving clockwise

Comprehensive Sign Plan Amendment  
Sign Dimensions and Areas



ad vice studios, LLC  
6400 mechanicsville turnpike  
suite 200  
mechanicsville, va 23111  
phone: (804) 730-0503  
fax: (804) 746-5210  
www.adviceStudios.com

Copyright ad vice studios, LLC 2015

This sign must be U.L. Listed and approved with external disconnect switch to match NEC.

ELECTRICAL REQUIREMENTS UNLESS OTHERWISE SPECIFIED:  
120 VOLT FOR MAX. OF 20-AMP CIRCUIT(S).

This drawing is the sole property of ad vice studios, LLC. Reproduction of these drawings is strictly prohibited without the written consent of ad vice studios, LLC. Use of this design in full or in part is strictly prohibited. All drawings and design concepts remain property of ad vice studios, LLC.

Customer Approval:

Date:

Client:

LINCOLN PROPERTY COMPANY

Project:

LINCOLN AT DISCOVERY SQUARE

Location:

HERNDON, VIRGINIA

Drawing #: X2.01

Scale: NONE

Date: MARCH 27, 2015

Revision #	Revision Date:
4	MAY 20, 2015
5	JUNE 30, 2015
6	AUGUST 4, 2015
7	SEPTEMBER 11, 2015
8	SEPTEMBER 29, 2015
9	OCTOBER 14, 2015

THIS PRINTED COLOR RENDERING IS INTENDED TO BETTER APPROXIMATE COLOR HUES AND DISTRIBUTION. BEST EFFORTS HAVE BEEN MADE TO SIMULATE THE ACTUAL COLOR(S).HOWEVER, EXACT COLOR(S) CAN ONLY BE SEEN FROM THE SPECIFIED COLOR SYSTEM'S CHIP OR SAMPLE.

All permits (including electrical permits, if required) and final electrical connection(s) for this/these sign(s) are by others

Sign Type/Description	Zoning Ordinance Section	Sign Dimensions (Width x Height)	Sign Height Above Grade	Article 12 Allowable Sign Area (Square Feet)	Total Proposed Sign Area (Square Feet)	Difference Between Proposed and Allowable
X5.01: Building Mounted Identification	12-202 (2)	2'10" x 38'2¼" = 108.2 SF 7'4" x 4'0" = 29.33 SF	57'	12 square feet	137.53 * 1 = 137.53 SF	+125.53 SF
X5.02-a: Building Mounted Identification	12-202 (2)	11'0" x 6'0" = 66.0 SF 37'2" x 2'8" = 99.11 SF	15'6"	12 square feet	165.11 * 1 = 165.11 SF	+153.11 SF
X5.03.01 & X5.03.02: Building Mounted Parking Identification Signs	12-103 (2) (G)	6'3¼" x 1'0" = 6.27 SF	13'5"	2 square feet	6.27 * 2 = 12.54 SF	+4.27 SF each + 8.54 SF total
X5.06: Building Mounted – Emergency Vehicle Sign	12-103 (2) (G)	2'6" x 1'6" = 3.75 SF	15'	2 square feet	3.75 * 1 = 3.75 SF	+1.75 SF
X5.04.01 & X5.04.02: Building Mounted Garage Identification Signs	12-103 (2) (G)	9'0" x 0'8" = 6 SF 9'0" x 0'8" = 6 SF	Approx. 9', final height dependent on garage clearance	2 square feet	12.00 * 2 = 24 SF	+10.00 SF each +20.00 SF total
BI.01-BI.12: Building Mounted Incidental Wall Signs	12-103 (2) (G)	2'1" x 1'11" = 4 SF	6'6"	2 square feet	4.00 * 12 = 48.00 SF	+2.00 SF each + 24.00 SF total

Comprehensive Sign Plan Amendment  
Sign Dimensions and Areas



ad vice studios, LLC  
6400 mechanicsville turnpike  
suite 200  
mechanicsville, va 23111  
phone: (804) 730-0503  
fax: (804) 746-5210  
www.adviceStudios.com

Copyright ad vice studios, LLC 2015

This sign must be U.L. Listed and approved with external disconnect switch to match NEC.

ELECTRICAL REQUIREMENTS UNLESS OTHERWISE SPECIFIED:  
120 VOLT FOR MAX. OF 20-AMP CIRCUIT(S).

This drawing is the sole property of ad vice studios, LLC. Reproduction of these drawings is strictly prohibited without the written consent of ad vice studios, LLC. Use of this design in full or in part is strictly prohibited. All drawings and design concepts remain property of ad vice studios, LLC.

Customer Approval:

Date:

Client:

LINCOLN PROPERTY COMPANY

Project:

LINCOLN AT DISCOVERY SQUARE

Location:

HERNDON, VIRGINIA

Drawing #: **X2.01**

Scale: NONE

Date: MARCH 27, 2015

Revision #	Revision Date:
4	MAY 20, 2015
5	JUNE 30, 2015
6	AUGUST 4, 2015
7	SEPTEMBER 11, 2015
8	SEPTEMBER 29, 2015
9	OCTOBER 14, 2015

THIS PRINTED COLOR RENDERING IS INTENDED TO BETTER APPROXIMATE COLOR HUES AND DISTRIBUTION. BEST EFFORTS HAVE BEEN MADE TO SIMULATE THE ACTUAL COLOR(S).HOWEVER, EXACT COLOR(S) CAN ONLY BE SEEN FROM THE SPECIFIED COLOR SYSTEM'S CHIP OR SAMPLE.

All permits (including electrical permits, if required) and final electrical connection(s) for this/these sign(s) are by others



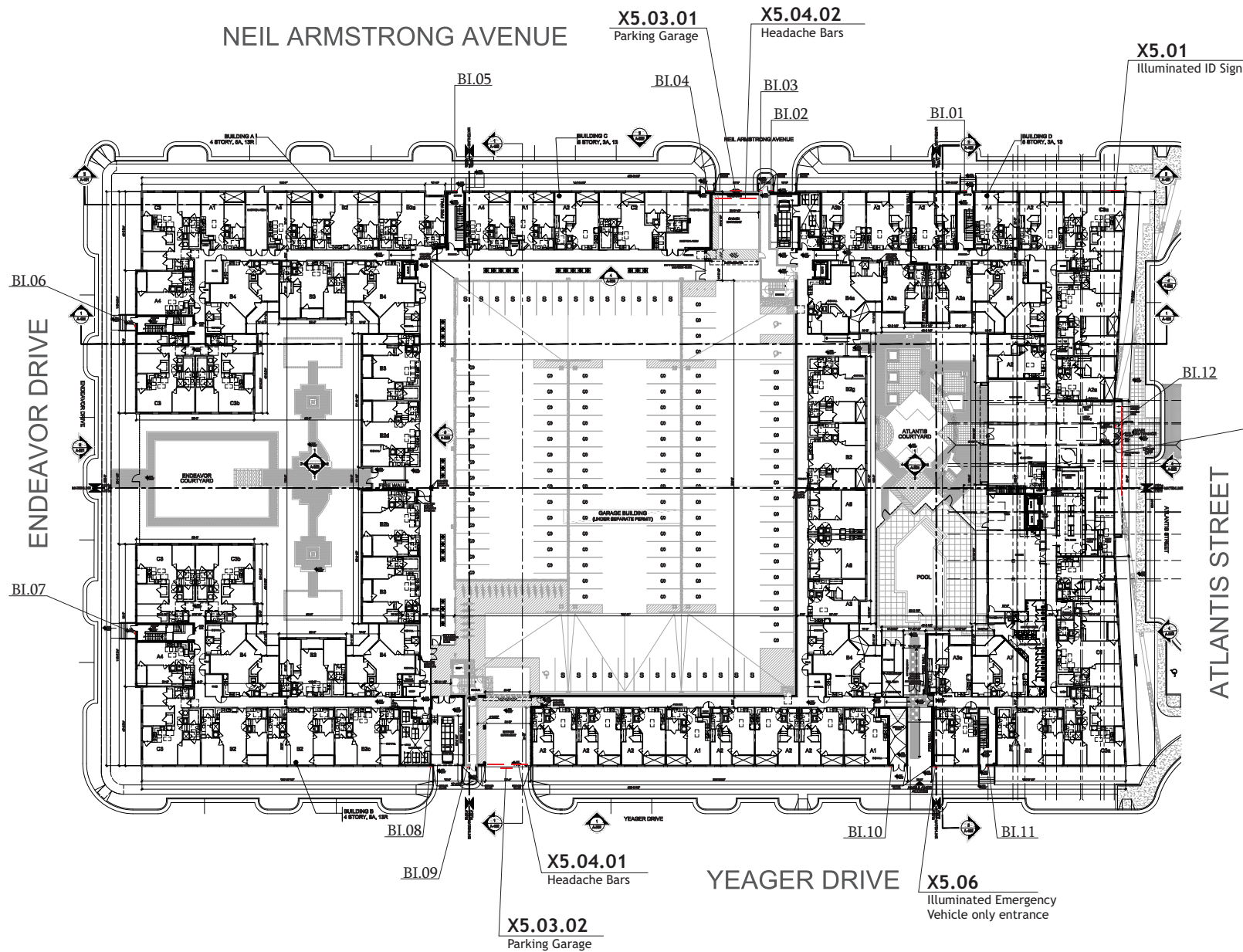

EXTERIOR SIGN LOCATION PLAN

Exterior Sign Plan Notes:

- a. The signs shall be built in substantial conformance with the designs illustrated in this package.
- b. Lighting of the signs shall be in accordance with Article 12 and Article 14 of the Fairfax County Zoning Ordinance.
- c. No signs shall be constructed within sight distance easements.
- d. Sign sizes depicted show the maximum square footage. Sign size may be reduced provided the sign is in substantial conformance with the signs depicted.
- e. Sign package does not regulate signs withing the building that are not visible from public rights-of-way.
- f. Location and orientation of the signs are subject to final design.
- g. Sign text shown here for illustrative purposes only. These signs provide the maximum square footage and general location; however, they do not regulate the proposed text.



ad vice studios, LLC  
6400 mechanicsville turnpike  
suite 200  
mechanicsville, va 23111  
phone: (804) 730-0503  
fax: (804) 746-5210  
www.adviceStudios.com  
Copyright ad vice studios, LLC 2015

This sign must be U.L. Listed and approved with external disconnect switch to match NEC.  
ELECTRICAL REQUIREMENTS UNLESS OTHERWISE SPECIFIED:  
120 VOLT FOR MAX. OF 20-AMP CIRCUIT(S).

This drawing is the sole property of ad vice studios, LLC. Reproduction of these drawings is strictly prohibited without the written consent of ad vice studios, LLC. Use of this design in full or in part is strictly prohibited. All drawings and design concepts remain property of ad vice studios, LLC.

Customer Approval:

Date:

Client:  
LINCOLN PROPERTY COMPANY

Project:  
LINCOLN AT DISCOVERY SQUARE

Location:  
HERNDON, VIRGINIA

Drawing #: X3.01

Scale: 1" = 80'-0"

Date: MARCH 27, 2015

Revision #	Revision Date:
4	MAY 20, 2015
5	JUNE 30, 2015
6	AUGUST 4, 2015
7	SEPTEMBER 11, 2015
8	SEPTEMBER 29, 2015
9	OCTOBER 14, 2015

THIS PRINTED COLOR RENDERING IS INTENDED TO BETTER APPROXIMATE COLOR HUES AND DISTRIBUTION. BEST EFFORTS HAVE BEEN MADE TO SIMULATE THE ACTUAL COLOR(S).HOWEVER, EXACT COLOR(S) CAN ONLY BE SEEN FROM THE SPECIFIED COLOR SYSTEM'S CHIP OR SAMPLE.

All permits (including electrical permits, if required) and final electrical connection(s) for this/these sign(s) are by others

SIGN X5.01

LETTER CABINET:

Fabricated aluminum cabinet painted to match building. "LINCOLN...SQUARE" copy to be routed out of .125" aluminum face with 1/2" thick translucent White push-thru letters. Internally illuminated with White LED's as required for even illumination. Mounted to face of building with non-corosive hardware as required.

Letter Area Square Footage:  
2'-10" x 38'-2 1/4" = 108.2' sq.ft.

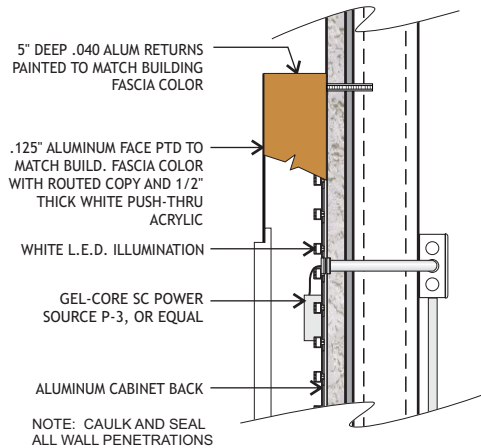

TYPICAL LETTER CABINET SECTION  
Not To Scale

Total Square Foot of Signage,  
calculated using 8 continuous  
straight lines, this Elevation  
108.2 + 29.33 = 137.53' sq.ft.

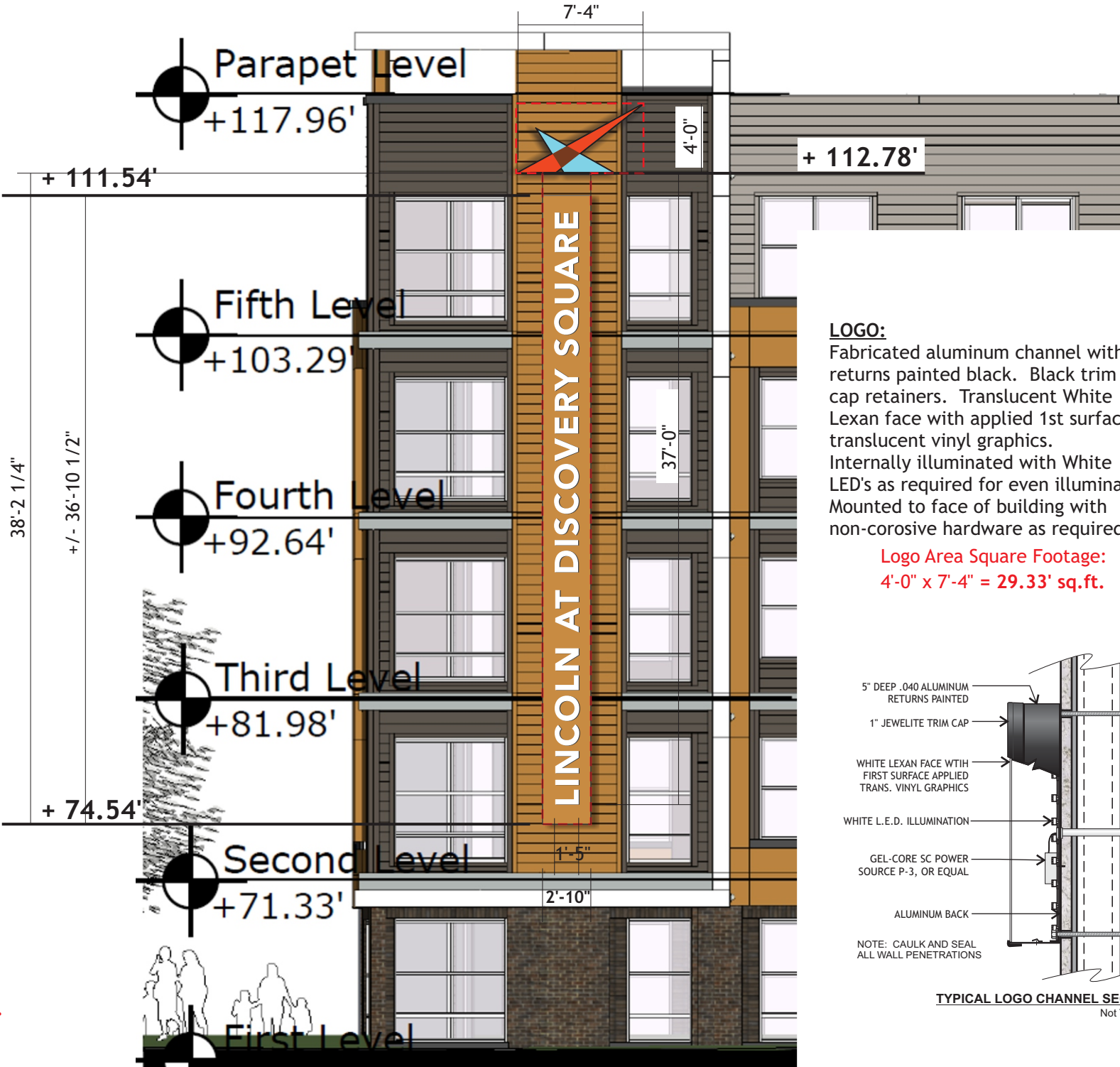

LOGO:

Fabricated aluminum channel with returns painted black. Black trim cap retainers. Translucent White Lexan face with applied 1st surface translucent vinyl graphics. Internally illuminated with White LED's as required for even illumination. Mounted to face of building with non-corosive hardware as required.

Logo Area Square Footage:  
4'-0" x 7'-4" = 29.33' sq.ft.

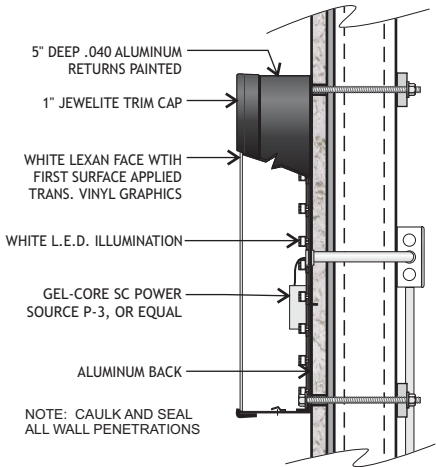

TYPICAL LOGO CHANNEL SECTION  
Not To Scale



ad vice studios, LLC  
6400 mechanicsville turnpike  
suite 200  
mechanicsville, va 23111  
phone: (804) 730-0503  
fax: (804) 746-5210  
www.adviceStudios.com

Copyright ad vice studios, LLC 2015

This sign must be U.L. Listed and  
approved with external  
disconnect switch to match NEC.  
ELECTRICAL REQUIREMENTS UNLESS  
OTHERWISE SPECIFIED:  
120 VOLT FOR MAX. OF 20-AMP CIRCUIT(S).

This drawing is the sole property of ad vice  
studios, LLC. Reproduction of these drawings  
is strictly prohibited without the written consent  
of ad vice studios, LLC. Use of this design in  
full or in part is strictly prohibited. All drawings  
and design concepts remain property of  
ad vice studios, LLC.

Customer Approval:

Date:

Client:  
LINCOLN PROPERTY COMPANY

Project:  
LINCOLN AT DISCOVERY SQUARE

Location:  
HERNDON, VIRGINIA

Drawing #: X5.01

Scale: 1/8" = 1'-0"

Date: MARCH 27, 2015

Revision #	Revision Date:
2	APRIL 15, 2015
3	MAY 19, 2015
4	MAY 20, 2015
5	JUNE 30, 2015
6	AUGUST 4, 2015
7	SEPTEMBER 2, 2015

THIS PRINTED COLOR RENDERING IS INTENDED TO  
BETTER APPROXIMATE COLOR HUES AND  
DISTRIBUTION. BEST EFFORTS HAVE BEEN MADE TO  
SIMULATE THE ACTUAL COLOR(S).HOWEVER, EXACT  
COLOR(S) CAN ONLY BE SEEN FROM THE  
SPECIFIED COLOR SYSTEM'S CHIP OR SAMPLE.

All permits (including  
electrical permits, if required)  
and final electrical  
connection(s) for this/these  
sign(s) are by others



SIGN X5.02 - CONCEPT a

CANOPY MOUNTED

**LOGO:**  
Fabricated aluminum channel with returns painted black. Black trim cap retainers. Translucent White Lexan face with applied 1st surface translucent vinyl graphics. Internally illuminated with White LED's as required for even illumination. Mounted to top of canopy with non-corrosive hardware as required.

Logo Area Square Footage:  
6'-0" x 11'-0" = 66.0' sq.ft.

**LETTER CABINET:**  
Fabricated aluminum cabinet painted to match building. "LINCOLN...SQUARE" copy to be routed out of .125" aluminum face with 1/2" thick translucent White push-thru letters. Internally illuminated with White LED's as required for even illumination. Mounted to top of canopy with non-corrosive hardware as required.

Letter Area Square Footage:  
2'-8" x 37'-2" = 99.11' sq.ft.

Total Square Foot of Signage,  
calculated using 8 continuous  
straight lines, this Elevation  
= 165.11' sq.ft.



PARTIAL ATLANTIS STREET BUILDING ELEVATION

\*\* See SHEET 2 for typical sign section details.



ad vice studios, LLC  
6400 mechanicsville turnpike  
suite 200  
mechanicsville, va 23111  
phone: (804) 730-0503  
fax: (804) 746-5210  
www.adviceStudios.com

Copyright ad vice studios, LLC 2015

This sign must be U.L. Listed and approved with external disconnect switch to match NEC.  
ELECTRICAL REQUIREMENTS UNLESS OTHERWISE SPECIFIED:  
120 VOLT FOR MAX. OF 20-AMP CIRCUIT(S).

This drawing is the sole property of ad vice studios, LLC. Reproduction of these drawings is strictly prohibited without the written consent of ad vice studios, LLC. Use of this design in full or in part is strictly prohibited. All drawings and design concepts remain property of ad vice studios, LLC.

Customer Approval:

Date:

Client:  
LINCOLN PROPERTY COMPANY

Project:  
LINCOLN AT DISCOVERY SQUARE

Location:  
HERNDON, VIRGINIA

Drawing #: X5.02-a

Scale: 3/32" = 1'-0"

Date: MARCH 27, 2015

Revision #	Revision Date:
2	APRIL 15, 2015
3	MAY 19, 2015
4	MAY 20, 2015
5	JUNE 30, 2015
6	AUGUST 4, 2015
7	SEPTEMBER 11, 2015

THIS PRINTED COLOR RENDERING IS INTENDED TO BETTER APPROXIMATE COLOR HUES AND DISTRIBUTION. BEST EFFORTS HAVE BEEN MADE TO SIMULATE THE ACTUAL COLOR(S).HOWEVER, EXACT COLOR(S) CAN ONLY BE SEEN FROM THE SPECIFIED COLOR SYSTEM'S CHIP OR SAMPLE.

All permits (including electrical permits, if required) and final electrical connection(s) for this/these sign(s) are by others

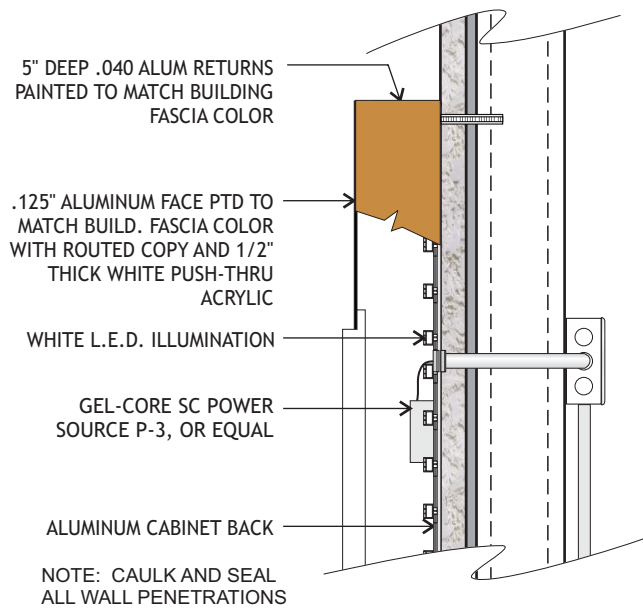

**TYPICAL LETTER CABINET SECTION**  
Not To Scale

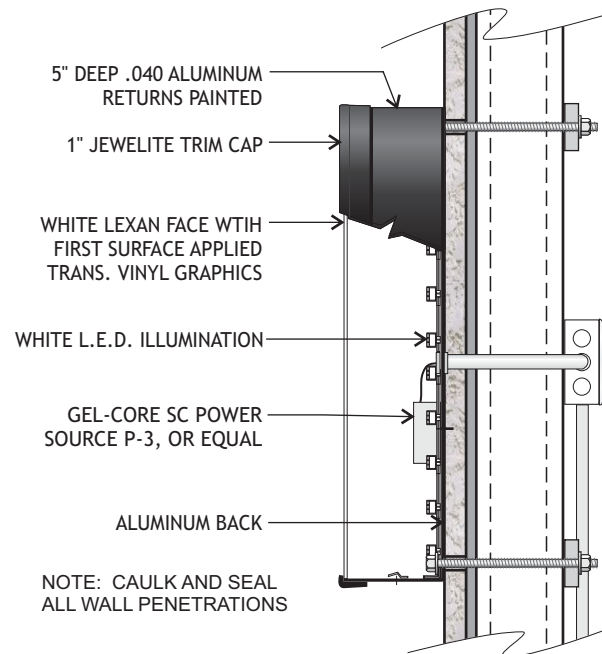

**TYPICAL LOGO CHANNEL SECTION**  
Not To Scale



ad vice studios, LLC  
6400 mechanicsville turnpike  
suite 200  
mechanicsville, va 23111  
phone: (804) 730-0503  
fax: (804) 746-5210  
www.adviceStudios.com

© Copyright ad vice studios, LLC 2015

This sign must be U.L. Listed and  
approved with external  
disconnect switch to match NEC.

ELECTRICAL REQUIREMENTS UNLESS  
OTHERWISE SPECIFIED:  
120 VOLT FOR MAX. OF 20-AMP CIRCUIT(S).

This drawing is the sole property of ad vice  
studios, LLC. Reproduction of these drawings  
is strictly prohibited without the written consent  
of ad vice studios, LLC. Use of this design in  
full or in part is strictly prohibited. All drawings  
and design concepts remain property of  
ad vice studios, LLC.

Customer Approval:

Date:

Client:

LINCOLN PROPERTY COMPANY

Project:

LINCOLN AT DISCOVERY SQUARE

Location:

HERNDON, VIRGINIA

Drawing #: **X5.02-a**

Scale: NONE

Date: MARCH 27, 2015

Revision #	Revision Date:
2	APRIL 15, 2015
3	MAY 19, 2015
4	MAY 20, 2015
5	JUNE 30, 2015
6	AUGUST 4, 2015
7	SEPTEMBER 11, 2015

THIS PRINTED COLOR RENDERING IS INTENDED TO  
BETTER APPROXIMATE COLOR HUES AND  
DISTRIBUTION. BEST EFFORTS HAVE BEEN MADE TO  
SIMULATE THE ACTUAL COLOR(S).HOWEVER, EXACT  
COLOR(S) CAN ONLY BE SEEN FROM THE  
SPECIFIED COLOR SYSTEM'S CHIP OR SAMPLE.

All permits (including  
electrical permits, if required)  
and final electrical  
connection(s) for this/these  
sign(s) are by others

SHEET 2



**SIGN X5.03.01 ELEVATION**  
3/8" = 1'-0"

**PARKING LETTERS:**

Fabricated aluminum channel with face and returns painted project orange. Clear lexan letter backs. Internally illuminated with White LED's as required for even illumination. Mounted to face of building with non-corosive hardware as required.

**Letter Area Square Footage:**  
**1'-0" x 6'-3 1/4" = 6.27' sq.ft.**

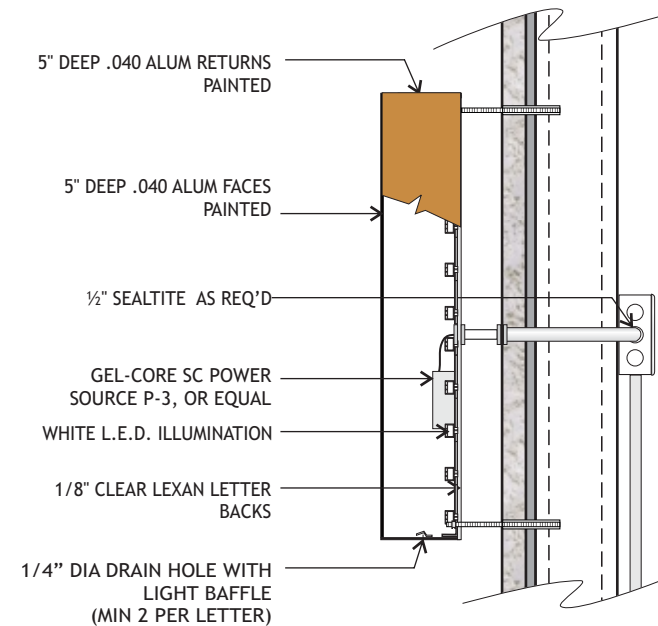

NOTE: CAULK AND SEAL ALL WALL PENETRATIONS

**TYPICAL LETTER SECTION**  
Not To Scale

**SIGN X5.03.01**  
**PARKING ENTRANCE SIGN**



ad vice studios, LLC  
6400 mechanicsville turnpike  
suite 200  
mechanicsville, va 23111  
phone: (804) 730-0503  
fax: (804) 746-5210  
www.adviceStudios.com

Copyright ad vice studios, LLC 2015

This sign must be U.L. Listed and approved with external disconnect switch to match NEC.

ELECTRICAL REQUIREMENTS UNLESS OTHERWISE SPECIFIED:  
120 VOLT FOR MAX. OF 20-AMP CIRCUIT(S).

This drawing is the sole property of ad vice studios, LLC. Reproduction of these drawings is strictly prohibited without the written consent of ad vice studios, LLC. Use of this design in full or in part is strictly prohibited. All drawings and design concepts remain property of ad vice studios, LLC.

Customer Approval:

Date:

Client:

**LINCOLN PROPERTY COMPANY**

Project:

**LINCOLN AT DISCOVERY SQUARE**

Location:

**HERNDON, VIRGINIA**

Drawing #: **X5.03.01**

Scale: 3/8" = 1'-0"

Date: MARCH 27, 2015

Revision #	Revision Date:
1	APRIL 2, 2015
2	APRIL 15, 2015
3	MAY 19, 2015
4	MAY 20, 2015
5	JUNE 30, 2015
6	AUGUST 4, 2015

THIS PRINTED COLOR RENDERING IS INTENDED TO BETTER APPROXIMATE COLOR HUES AND DISTRIBUTION. BEST EFFORTS HAVE BEEN MADE TO SIMULATE THE ACTUAL COLOR(S).HOWEVER, EXACT COLOR(S) CAN ONLY BE SEEN FROM THE SPECIFIED COLOR SYSTEM'S CHIP OR SAMPLE.

**All permits (including electrical permits, if required) and final electrical connection(s) for this/these sign(s) are by others**





**SIGN X5.03.02 ELEVATION**  
3/8" = 1'-0"

**PARKING LETTERS:**  
Fabricated aluminum channel with face and returns painted project orange. Clear lexan letter backs. Internally illuminated with White LED's as required for even illumination. Mounted to face of building with non-corosive hardware as required.

**Letter Area Square Footage:**  
1'-0" x 6'-3 1/4" = 6.27' sq.ft.

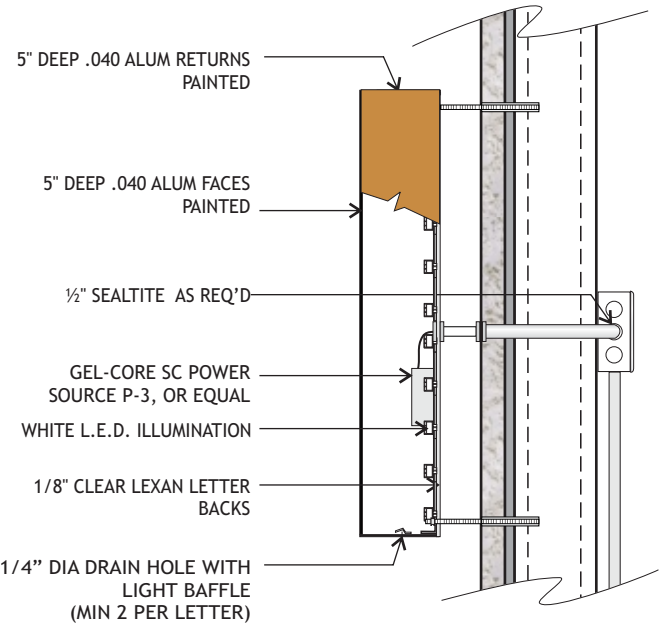

NOTE: CAULK AND SEAL ALL WALL PENETRATIONS

**TYPICAL LETTER SECTION**  
Not To Scale

**SIGN X5.03.02**



ad vice studios, LLC  
6400 mechanicsville turnpike  
suite 200  
mechanicsville, va 23111  
phone: (804) 730-0503  
fax: (804) 746-5210  
www.adviceStudios.com

Copyright ad vice studios, LLC 2015

This sign must be U.L. Listed and approved with external disconnect switch to match NEC.

ELECTRICAL REQUIREMENTS UNLESS OTHERWISE SPECIFIED:  
120 VOLT FOR MAX. OF 20-AMP CIRCUIT(S).

This drawing is the sole property of ad vice studios, LLC. Reproduction of these drawings is strictly prohibited without the written consent of ad vice studios, LLC. Use of this design in full or in part is strictly prohibited. All drawings and design concepts remain property of ad vice studios, LLC.

Customer Approval:

Date:

Client:

LINCOLN PROPERTY COMPANY

Project:

LINCOLN AT DISCOVERY SQUARE

Location:

HERNDON, VIRGINIA

Drawing #: **X5.03.02**

Scale: NOTED

Date: MARCH 27, 2015

Revision #	Revision Date:
1	APRIL 2, 2015
2	APRIL 15, 2015
3	MAY 19, 2015
4	MAY 20, 2015
5	JUNE 30, 2015
6	AUGUST 4, 2015

THIS PRINTED COLOR RENDERING IS INTENDED TO BETTER APPROXIMATE COLOR HUES AND DISTRIBUTION. BEST EFFORTS HAVE BEEN MADE TO SIMULATE THE ACTUAL COLOR(S).HOWEVER, EXACT COLOR(S) CAN ONLY BE SEEN FROM THE SPECIFIED COLOR SYSTEM'S CHIP OR SAMPLE.

All permits (including electrical permits, if required) and final electrical connection(s) for this/these sign(s) are by others



Headache Bar Square Footage:  
8" x 9'-0" = 6' sq.ft.



**B (rear) Elevation**  
8" Dia. x 1/4" wall PVC painted red PMS #200C with applied reflective white vinyl copy.  
Hung with chains and 3/8" Dia. x 5" long lag and sheild bolts.

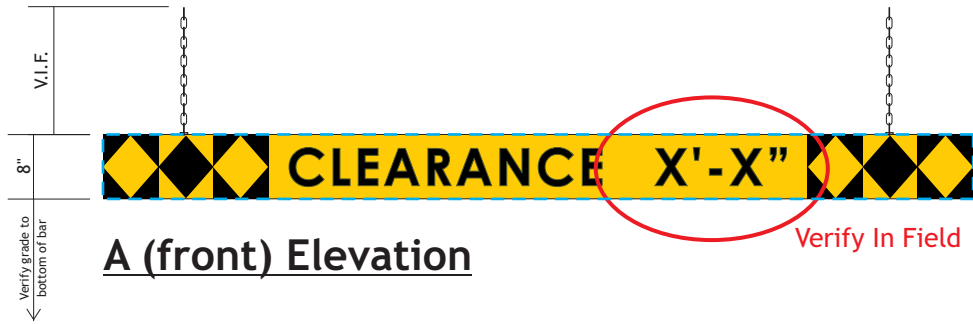

Headache Bar Square Footage:  
8" x 9'-0" = 6' sq.ft.



**B (rear) Elevation**  
8" Dia. x 1/4" wall PVC painted yellow PMS #123C with applied reflective black vinyl graphics.  
Hung with chains and 3/8" Dia. x 5" long lag and sheild bolts.  
\* Verify clearance height and copy on bar.

Total Headache Bar Square Footage: 12' sq.ft.

SIGN X5.04.01  
HEADACHE BARS



ad vice studios, LLC  
6400 mechanicsville turnpike  
suite 200  
mechanicsville, va 23111  
phone: (804) 730-0503  
fax: (804) 746-5210  
www.adviceStudios.com  
© Copyright ad vice studios, LLC 2015

This sign must be U.L. Listed and approved with external disconnect switch to match NEC.  
ELECTRICAL REQUIREMENTS UNLESS OTHERWISE SPECIFIED:  
120 VOLT FOR MAX. OF 20-AMP CIRCUIT(S).  
This drawing is the sole property of ad vice studios, LLC. Reproduction of these drawings is strictly prohibited without the written consent of ad vice studios, LLC. Use of this design in full or in part is strictly prohibited. All drawings and design concepts remain property of ad vice studios, LLC.

Customer Approval:

Date:

Client:  
LINCOLN PROPERTY COMPANY

Project:  
LINCOLN AT DISCOVERY SQUARE

Location:  
HERNDON, VIRGINIA

Drawing #: X5.04.01

Scale: 1/2" = 1'-0"

Date: MARCH 27, 2015

Revision #	Revision Date:
1	APRIL 2, 2015
2	APRIL 15, 2015
3	MAY 19, 2015
4	MAY 20, 2015
5	JUNE 30, 2015
6	AUGUST 4, 2015

THIS PRINTED COLOR RENDERING IS INTENDED TO BETTER APPROXIMATE COLOR HUES AND DISTRIBUTION. BEST EFFORTS HAVE BEEN MADE TO SIMULATE THE ACTUAL COLOR(S).HOWEVER, EXACT COLOR(S) CAN ONLY BE SEEN FROM THE SPECIFIED COLOR SYSTEM'S CHIP OR SAMPLE.

All permits (including electrical permits, if required) and final electrical connection(s) for this/these sign(s) are by others



Headache Bar Square Footage:  
8" x 9'-0" = 6' sq.ft.



8" Dia. x 1/4" wall PVC painted red PMS #200C with applied reflective white vinyl copy.  
Hung with chains and 3/8" Dia. x 5" long lag and sheild bolts.

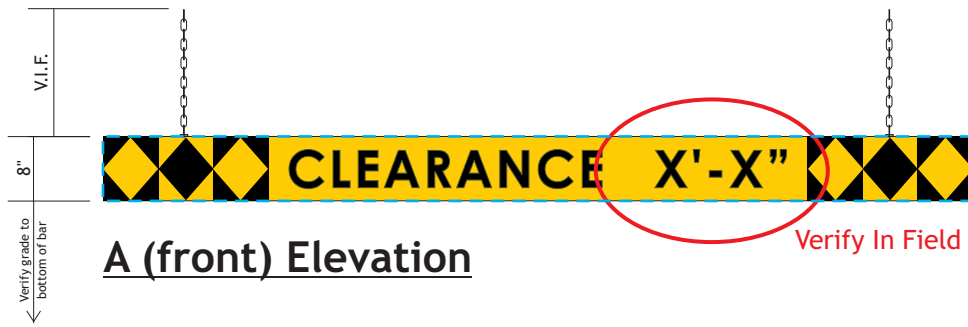

Headache Bar Square Footage:  
8" x 9'-0" = 6' sq.ft.



8" Dia. x 1/4" wall PVC painted yellow PMS #123C with applied reflective black vinyl graphics.  
Hung with chains and 3/8" Dia. x 5" long lag and sheild bolts.  
\* Verify clearance height and copy on bar.

Total Headache Bar Square Footage: 12' sq.ft.

# SIGN X5.04.02

## HEADACHE BARS



ad vice studios, LLC  
6400 mechanicsville turnpike  
suite 200  
mechanicsville, va 23111  
phone: (804) 730-0503  
fax: (804) 746-5210  
www.adviceStudios.com

Copyright ad vice studios, LLC 2015

This sign must be U.L. Listed and  
approved with external  
disconnect switch to match NEC.

ELECTRICAL REQUIREMENTS UNLESS  
OTHERWISE SPECIFIED:  
120 VOLT FOR MAX. OF 20-AMP CIRCUIT(S).

This drawing is the sole property of ad vice  
studios, LLC. Reproduction of these drawings  
is strictly prohibited without the written consent  
of ad vice studios, LLC. Use of this design in  
full or in part is strictly prohibited. All drawings  
and design concepts remain property of  
ad vice studios, LLC.

Customer Approval:

Date:

Client:

LINCOLN PROPERTY COMPANY

Project:

LINCOLN AT DISCOVERY SQUARE

Location:

HERNDON, VIRGINIA

Drawing #: X5.04.02

Scale: 1/2" = 1'-0"

Date: MARCH 27, 2015

Revision #	Revision Date:
1	APRIL 2, 2015
2	APRIL 15, 2015
3	MAY 19, 2015
4	MAY 20, 2015
5	JUNE 30, 2015
6	AUGUST 4, 2015

THIS PRINTED COLOR RENDERING IS INTENDED TO  
BETTER APPROXIMATE COLOR HUES AND  
DISTRIBUTION. BEST EFFORTS HAVE BEEN MADE TO  
SIMULATE THE ACTUAL COLOR(S).HOWEVER, EXACT  
COLOR(S) CAN ONLY BE SEEN FROM THE  
SPECIFIED COLOR SYSTEM'S CHIP OR SAMPLE.

All permits (including  
electrical permits, if required)  
and final electrical  
connection(s) for this/these  
sign(s) are by others



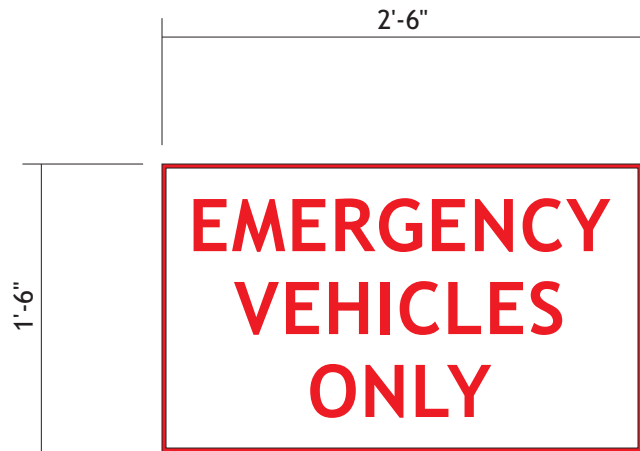

**SIGN X5.06 ELEVATION**

1" = 1'-0"

**EMERGENCY:**  
Flat aluminum panel with applied reflective  
White and Red vinyl graphics.  
Mounted to face of building with  
non-corosive hardware as required.

**Sign Area Square Footage:**  
**1'-6" x 2'-6" = 3.75' sq.ft.**

**SIGN X5.06**  
**EMERGENCY VEHICLE ONLY**  
**ENTRANCE SIGN**



ad vice studios, LLC  
6400 mechanicsville turnpike  
suite 200  
mechanicsville, va 23111  
phone: (804) 730-0503  
fax: (804) 746-5210  
www.adviceStudios.com

Copyright ad vice studios, LLC 2015

This sign must be U.L. Listed and  
approved with external  
disconnect switch to match NEC.  
ELECTRICAL REQUIREMENTS UNLESS  
OTHERWISE SPECIFIED:  
120 VOLT FOR MAX. OF 20-AMP CIRCUIT(S).

This drawing is the sole property of ad vice  
studios, LLC. Reproduction of these drawings  
is strictly prohibited without the written consent  
of ad vice studios, LLC. Use of this design in  
full or in part is strictly prohibited. All drawings  
and design concepts remain property of  
ad vice studios, LLC.

Customer Approval:

Date:

Client:  
**LINCOLN PROPERTY COMPANY**

Project:  
**LINCOLN AT DISCOVERY SQUARE**

Location:  
**HERNDON, VIRGINIA**

Drawing #: **X5.06**

Scale: NOTED

Date: MARCH 27, 2015

Revision #	Revision Date:
2	APRIL 15, 2015
3	MAY 19, 2015
4	MAY 20, 2015
5	JUNE 30, 2015
6	AUGUST 4, 2015
7	SEPTEMBER 29, 2015

THIS PRINTED COLOR RENDERING IS INTENDED TO  
BETTER APPROXIMATE COLOR HUES AND  
DISTRIBUTION. BEST EFFORTS HAVE BEEN MADE TO  
SIMULATE THE ACTUAL COLOR(S).HOWEVER, EXACT  
COLOR(S) CAN ONLY BE SEEN FROM THE  
SPECIFIED COLOR SYSTEM'S CHIP OR SAMPLE.

**All permits (including  
electrical permits, if required)  
and final electrical  
connection(s) for this/these  
sign(s) are by others**

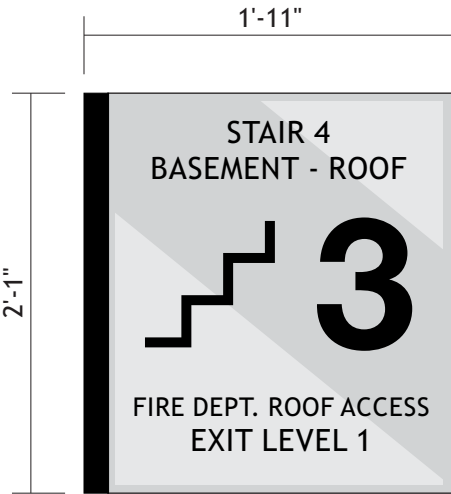

**BUILDING INCIDENTAL WALL SIGN  
EXAMPLE - 1**  
4' square ft.

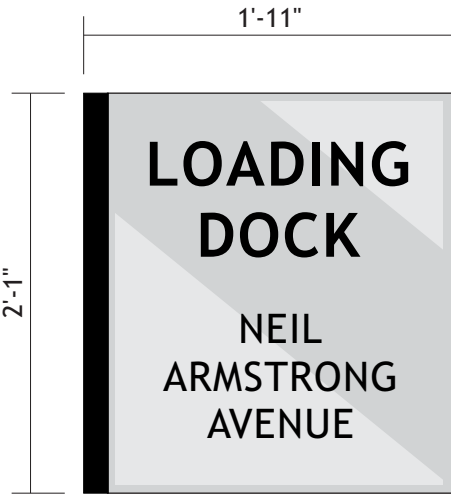

**BUILDING INCIDENTAL WALL SIGN  
EXAMPLE - 2**  
4' square ft.

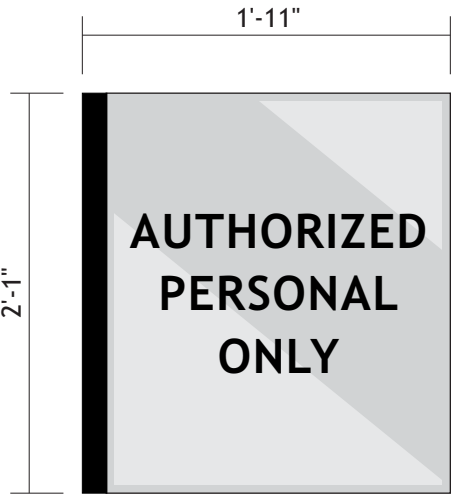

**BUILDING INCIDENTAL WALL SIGN  
EXAMPLE - 3**  
4' square ft.

**SIGN BI.00 EXAMPLES**  
**BUILDING INCIDENTAL  
WALL SIGNS**



ad vice studios, LLC  
6400 mechanicsville turnpike  
suite 200  
mechanicsville, va 23111  
phone: (804) 730-0503  
fax: (804) 746-5210  
www.adviceStudios.com

 Copyright ad vice studios, LLC 2015

This sign must be U.L. Listed and approved with external disconnect switch to match NEC.

ELECTRICAL REQUIREMENTS UNLESS OTHERWISE SPECIFIED:  
120 VOLT FOR MAX. OF 20-AMP CIRCUIT(S).

This drawing is the sole property of ad vice studios, LLC. Reproduction of these drawings is strictly prohibited without the written consent of ad vice studios, LLC. Use of this design in full or in part is strictly prohibited. All drawings and design concepts remain property of ad vice studios, LLC.

Customer Approval:

Date:

Client:  
**LINCOLN PROPERTY COMPANY**

Project:  
**LINCOLN AT DISCOVERY SQUARE**

Location:  
**HERNDON, VIRGINIA**

Drawing #: **BI.00 EXAMPLES**

Scale: 1" = 1'-0"

Date: MARCH 27, 2015

Revision #	Revision Date:
2	APRIL 15, 2015
3	MAY 19, 2015
4	MAY 20, 2015
5	JUNE 30, 2015
6	AUGUST 4, 2015
7	SEPTEMBER 29, 2015

THIS PRINTED COLOR RENDERING IS INTENDED TO BETTER APPROXIMATE COLOR HUES AND DISTRIBUTION. BEST EFFORTS HAVE BEEN MADE TO SIMULATE THE ACTUAL COLOR(S).HOWEVER, EXACT COLOR(S) CAN ONLY BE SEEN FROM THE SPECIFIED COLOR SYSTEM'S CHIP OR SAMPLE.

**All permits (including electrical permits, if required) and final electrical connection(s) for this/these sign(s) are by others**