

**LEGEND**

- 402--- EXISTING CONTOUR
- 400--- EXISTING INDEX CONTOUR
- --- LIMITS OF CLEARING & GRADING
- --- EXISTING TREELINE
- --- PROPOSED TREELINE
- --- EX. ZONING BOUNDARY
- --- EX. STORM DRAIN & EASEMENT
- --- PROPOSED STORM DRAIN
- --- EX. SAN. SEWER & EASEMENT
- --- PROPOSED SANITARY SEWER
- --- EX. WATERMAIN & EASEMENT
- --- PROPOSED WATERMAIN
- --- EX. GAS MAIN
- --- EXISTING UTILITY LINE & POLE
- --- EXISTING STREET LIGHT
- --- VEHICLES PER DAY COUNT
- --- PROPOSED COVERED WALKWAY

NOTE : WALL HEIGHTS ARE LABELED ON THE HIGHER SIDE

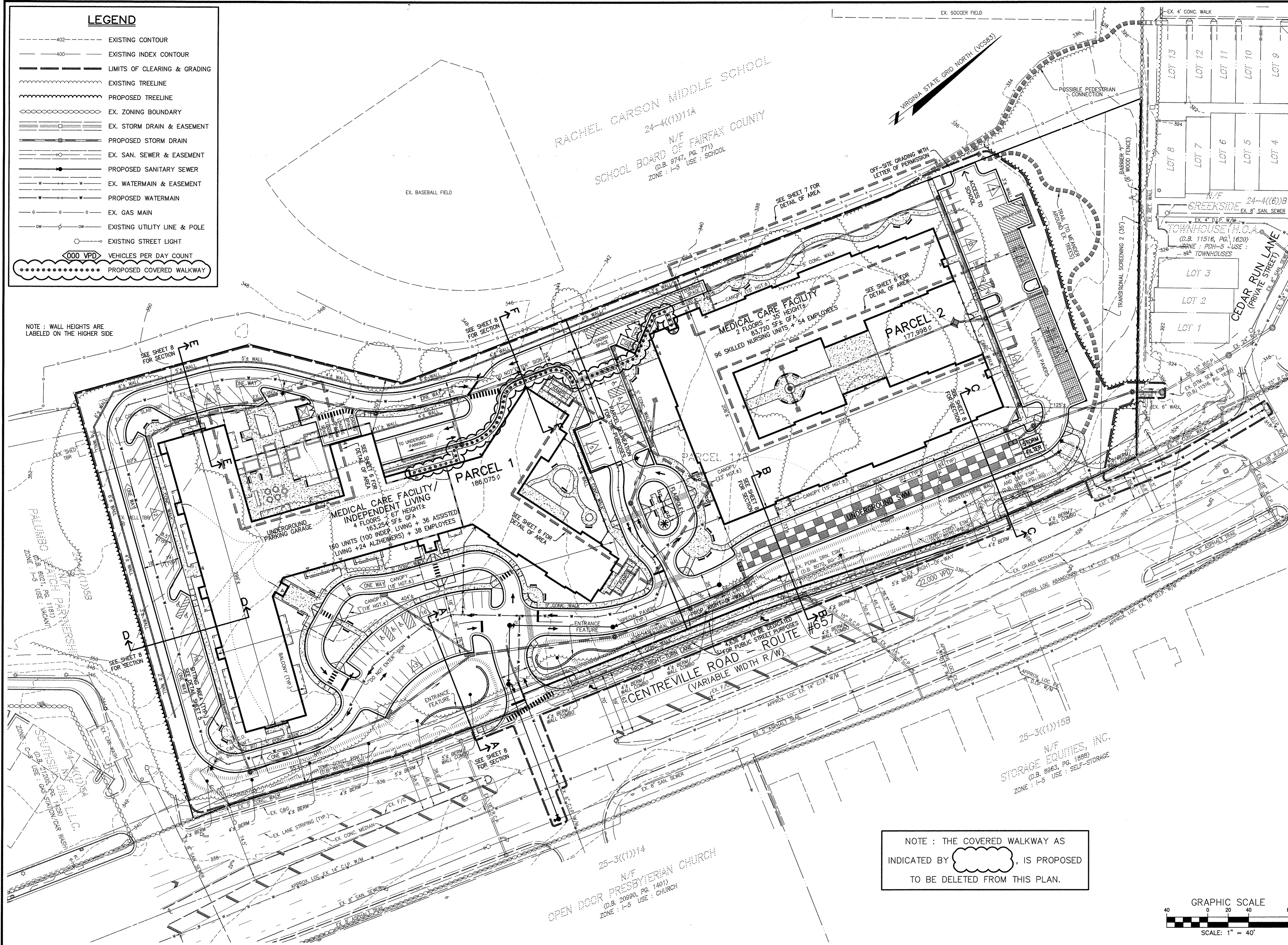

NOTE : THE COVERED WALKWAY AS INDICATED BY IS PROPOSED TO BE DELETED FROM THIS PLAN.

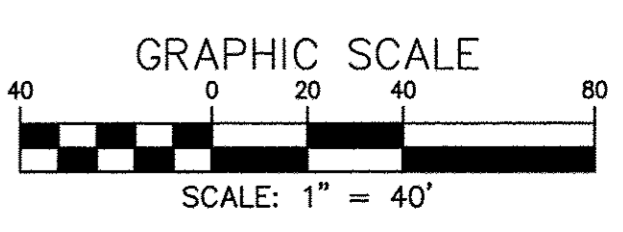

CONCEPTUAL / FINAL DEVELOPMENT PLAN  
**CHANTILLY NURSING AND REHABILITATION CENTER**

BRIAN R. THOMAS  
Lic. No. 039837  
PROFESSIONAL ENGINEER

NO.	DATE	DESCRIPTION	BY	APPROVED
1	REMOVED COVERED WALKWAY (2-14-17)	KJV		

DESIGN DRAFT KJV

APPROVED HMF

DATE APR. 2012

SCALE HORIZ: 1" = 40'

VERT: ---

SHEET 4 OF 13

PRJ NO: 11-576

TYPE: CDP / FDP

25-3(0)114 N/F SCHOOL BOARD OF FAIRFAX COUNTY (D.B. 9747, PG. 771) ZONE : I-5 USE : SCHOOL

25-3(0)115 N/F STORAGE EQUIP. INC. (D.B. 8963, PG. 1898) ZONE : I-5 USE : SELF-STORAGE

25-3(0)158 N/F OPEN DOOR PRESBYTERIAN CHURCH (D.B. 20890, PG. 1401) ZONE : I-5 USE : CHURCH

Charles P. Johnson & Associates, Inc.  
Civil and Environmental Engineers • Planners • Landscape Architects • Surveyors  
3959 Pender Dr., Ste. 210 Fairfax, VA 22030 703-585-7555 Fax: 703-273-8695  
www.cpa.com • Silver Spring, MD • Gaithersburg, MD • Annapolis, MD • College Park, MD • Frederick, MD • Fairfax, VA

Last Saved 2/14/2017 Last Plotted 2/14/2017 2:20 PM Sheet N:\11576\DWG\00-F0611