







# KCPC

## Special Exception Amendment

### Child Care Center and School of Education

12. The school of education will be limited to grades kindergarten through ~~6<sup>th</sup>-8<sup>th</sup>~~ grade, with a maximum daily enrollment of 100 students.\*

- Current: (Total 200 students)
  - Preschool :100 students & K-6<sup>th</sup> grade: 100 Students
- Amendment for this year.
  - Preschool: 100 students & K-8<sup>th</sup> grade: 100 students





# THE SENT

## CHRISTIAN SCHOOL

*equipping the next generation in Christ-like leadership*



# THE SENT CHRISTIAN SCHOOL

- Dedicated, experienced teachers with 5+ years in classroom
- High focus on development of good character and Biblical values
- Hand-Picked Curriculum
- Safe, Family Environment
- Higher academic standards
- More individualized attention for students who need extra support
- Smaller classroom size and teacher/student ratio allows for greater individualized attention (1:12)

# UPDATES

1. KCPC is about to submit a permit set to the County.
2. The plan drawings did not change from the original plan and the land development includes a grass field, basketball court, playground, picnic shelters, and parking lot expansion.
3. Construction is likely to start in the late summer and it will take about a year.



41220-07 HIGHWAY  
 MAP # 0411-01-028  
**KOREAN CENTRAL  
 PRESBYTERIAN CHURCH**  
 SEE 0300-0204 PAGE 1-100  
 ZONED R-C  
 12-41

41220-07 HIGHWAY  
 MAP # 0411-01-028  
**KOREAN CENTRAL  
 PRESBYTERIAN CHURCH**  
 SEE 0300-0204 PAGE 1-100  
 ZONED R-C

41220-07 HIGHWAY  
 MAP # 0411-01-028  
**KOREAN CENTRAL  
 PRESBYTERIAN CHURCH**  
 SEE 0300-0204 PAGE 1-100  
 ZONED R-C

FAIRFAX COUNTY  
**SCHOOL BOARD**  
 SEE 0300-0204 PAGE 1-101  
 ZONED R-C  
 USE: PUBLIC SCHOOL

NO.	DESCRIPTION	REV. BY	APPROVED	DATE

REVISION APPROVED BY  
 SITE DEVELOPMENT AND INSPECTIONS DIVISION

**christopher**   
 consultants

3001 Innovation Dr., Suite 100  
 Manassas, VA 20110 P 703-390-9687  
 engineering • surveying • land planning

**KOREAN CENTRAL  
 PRESBYTERIAN CHURCH**  
 SITE PLAN

SALLY DISTRICT  
 FAIRFAX COUNTY PROGRAM

NO.	DATE	DESCRIPTION

PROJECT NO. 200805000  
 DRAWING NO. 11243  
 DATE: 03/25/21  
 SCALE: AS SHOWN  
 DESIGNED BY: DAZY  
 CHECKED BY: CM

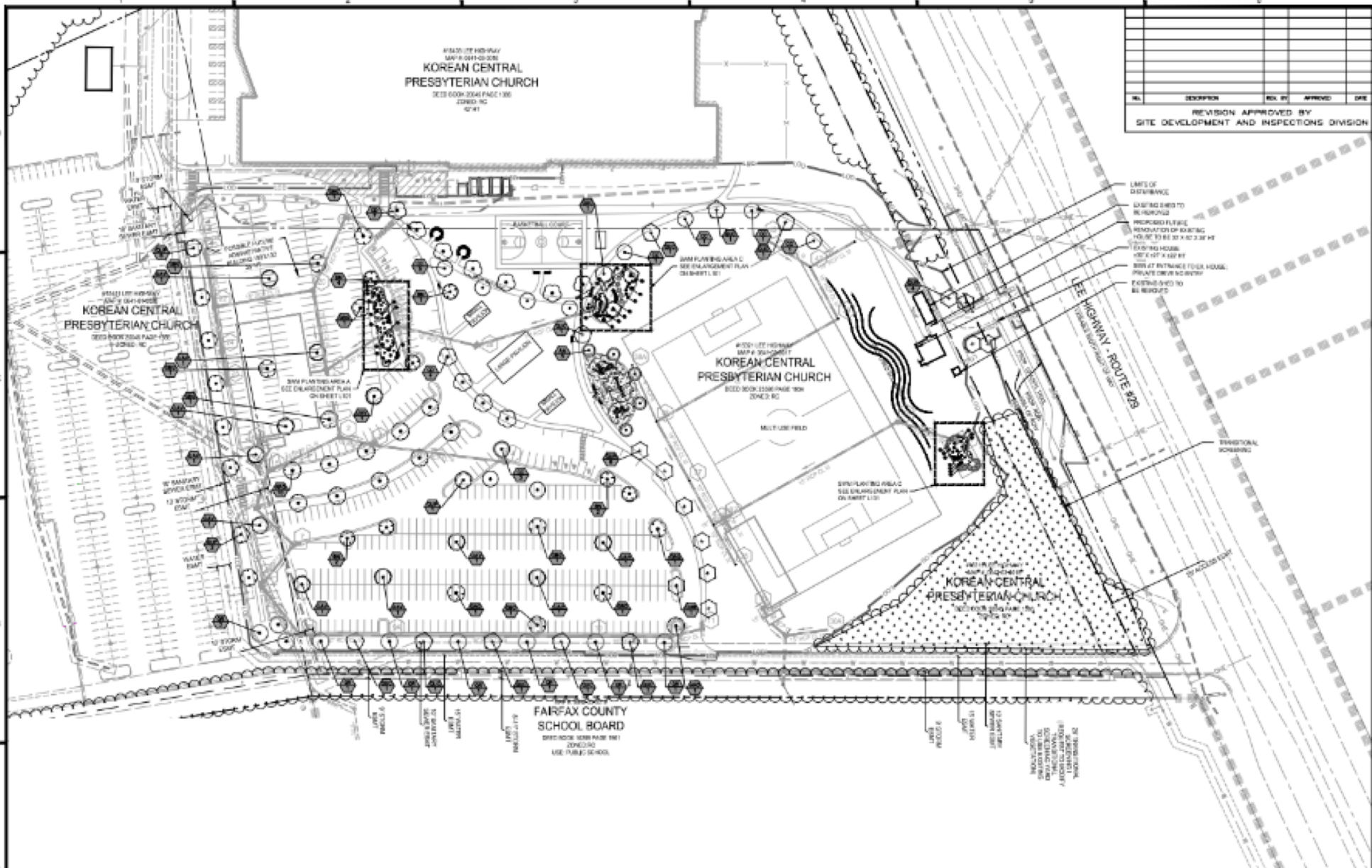

PROFESSIONAL ARCHITECTS & ENGINEERS, REGISTERED PROFESSIONAL ENGINEERS, LICENSED PROFESSIONAL SURVEYORS, VA



# Q & A

